



# HINO 700 SERIES

SR1EKR

6 X 2 PRIME MOVER  
GCW 66,000KG



**HINO MOTORS SALES (MALAYSIA) SDN BHD** (187863-U)

**Selangor:** Lot PT. 24, Jalan 223, Section 51A, 46100 Petaling Jaya, Selangor Darul Ehsan, Malaysia. Tel: (603) 7957 5199 (12 talian) Faks: (603) 7954 3276 / 7957 2235

**Sarawak:** Lot 3477, Block 226 KNLD, Off Jalan Datuk Amar Kalong Ningkan, 93250 Kuching, Sarawak, Malaysia. Tel: (082) 451 611 (5 talian) Faks: (082) 451 993

**Sabah:** Mile 4½, Tuaran Road, Lot No. 353, Taman Cempaka, Likas, 88450 Kota Kinabalu, Sabah, Malaysia. Tel: (088) 393 663 Faks: (088) 424 223

[www.hino.com.my](http://www.hino.com.my)

# PERFORMANCE



AMT 6 x 2  
PRIME MOVER



## LIFT DOWN SWITCH

Manual switch allows drivers to have the flexibility to lower the 3rd axle when required.



## LIFTABLE 3RD AXLE

Improved operation flexibility with lower tire wear and tear, better fuel efficiency while maintaining high loading capacity with the liftable axle.

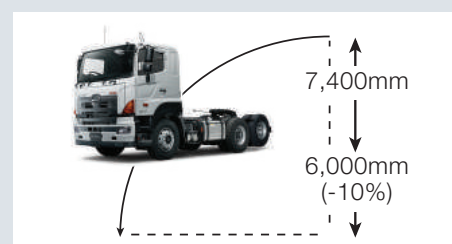

## BETTER MANEUVERABILITY (BETTER TURNING RADIUS)

In narrow situations, small turning radius is preferable. By lifting of the last axle, our turning radius is improved by almost 10% making it easier to maneuver in tight spots.

<Turning radius (on tire)>

- 3 axle operation (Lift down) = 7,400mm
- 2 axle operation (Lift up) = 6,000mm (~10%)

## ADJUSTABLE COUPLER HEIGHT

Coupler height can be adjusted with just a press of a switch. This helps improve efficiency during coupling at uneven surface height.

# COMFORTABILITY



## OPTIMIZED CAB SPACE

Better visibility and operability, spacious and quality interior provide drivers the comfort they need.



## HIGH-FUNCTIONALITY SEATS

3D body cradling form and seat suspension, the high-functionality seat provides superior seating comfort. Air lumbar support with two position backrest that support driver's back comfortably.



## CAB ACCESSIBILITY

The first step is now connected directly to the chassis, bringing it closer to ground level. Cabin access is also easier and safer due to new, optimized 3-step pitch. The larger door openings and footsteps allow easy access to enter and exit.



Rear

## SUSPENSION

The suspension system offers improved ride comfort and stability on rough road condition.

# APPLICATION

## BODY TYPE

A truck for every application of bodies suit your type of business.

● Drive Axle

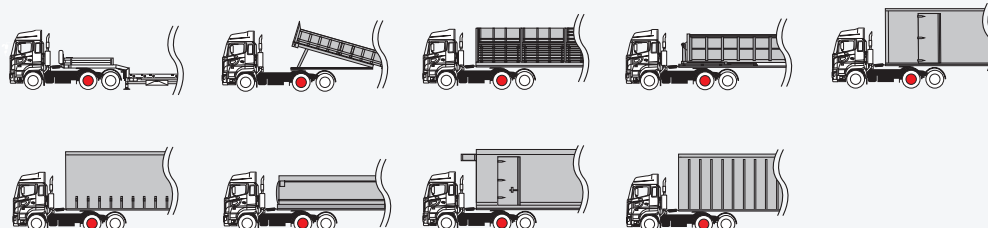

Note: Some images may be used for illustration purposes only.



**EURO3**

ENGINE MODEL  
**E13C-TM**

**DISPLACEMENT :**

12,913cc, 6-cylinder in-line,  
Turbo-Charged Intercooler,  
Commonrail

**ENGINE OUTPUT :**

309kW (420PS) / 1,800rpm

**E/G TORQUE :**

1,903Nm (194kgfm) / 1,100rpm

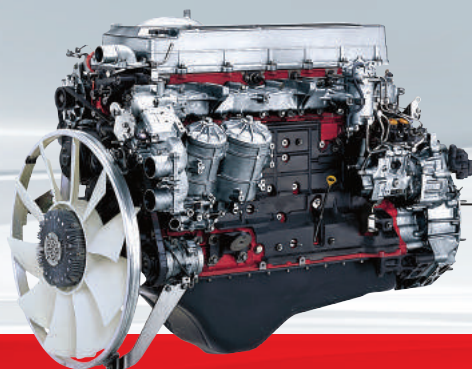

**SR1EKR**

## SAFETY

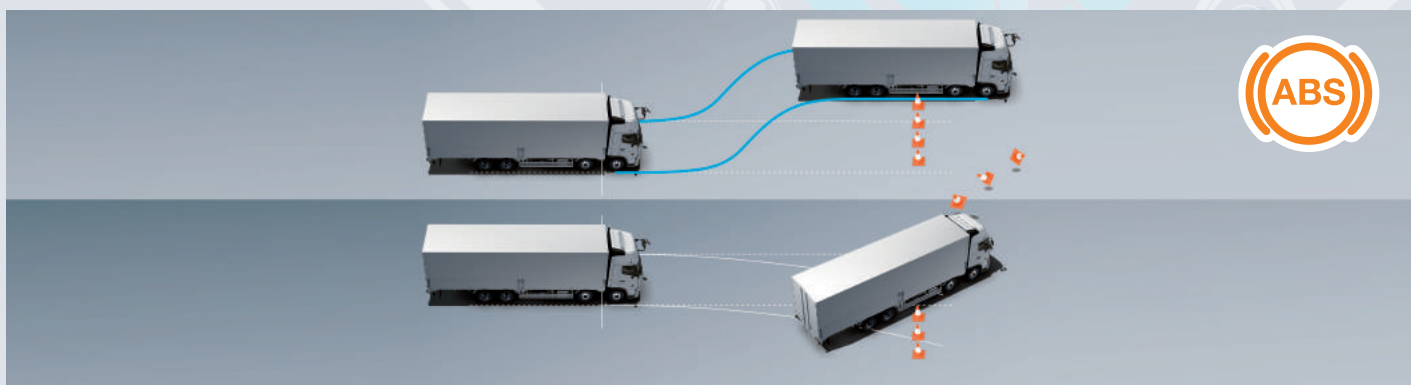

### ANTILOCK BRAKING SYSTEM (ABS)

ABS helps the driver maintain control of the vehicle when braking on a slippery surface by selectively controlling the braking force of individual wheel in order to prevent the wheels from locking.



### DOOR IMPACT BEAMS

High-rigidity door impact beams at the side help to increase driver and passenger safety from a side collision.



### SRS AIRBAG

SRS driver airbags complement seatbelts to help reduce shock in any event of a frontal impact collision.



### FRONT UNDER RUN PREVENTION (FUP)

Prevent underrunning in the event of head-on or impact collision.



### ENERGY-ABSORBING STEERING COLUMN

Energy-absorbing steering wheel and tilt/telescope steering column help to absorb some impact in case of collision that providing better protection for the driver.



### AMT GEAR

The outstanding ZF 16 speed fully automated manual transmission (AMT) is easy and comfortable to drive, reducing driver fatigue and even improving fuel consumption under certain conditions. Driver also has the option to select a sequential manual mode for on-demand shifting conditions.



**AMT MODEL**

# SPECIFICATIONS



## SR1EKR-MRM (AMT)

Engine	Model		HINO E13C - TM (EURO 3)	
	Type		Diesel, 6-Cylinder, Vertical-in-line, Overhead Cam, Water Cooled	
	Displacement	cc	12,913	
	Max. Output (JIS Gross)	kW (PS / rpm)	309 (420) / 1,800	
	Max. Torque (JIS Gross)	Nm (Kgfm / rpm)	1,903 (194) / 1,100	
	Bore & Stroke	mm	137 × 146	
	Fuel Injection System		Electronic Control, Common Rail Type	
Clutch	Max. Engine Speed	Rpm	2,150	
	Type		Dry Single Plate With Damper Springs Ø 430mm	
Transmission	Control		Hydraulic with Air Booster	
	Model		ZF16TX2440TO	
	Type		Sixteen (16) Forward and Two (2) Reverse Speeds, Overdrive	
	Control		Mechanical Auto	
Axle	Front	Type	Reversed Elliot, "I" section beam	
		Capacity kg	7,500	
	Rear	Type	Full-Floating, Single Reduction, Single Speed by Hypoid Gearing	
		Capacity kg	23,500	
Brake	Service Brake Type		"S" Cam Type, Drum Brake, Anti Lock Braking System (ABS), Full Air, Dual Circuit	
	Parking Brake Type		Spring Brake, Acting on Front and Rear Frontward Wheels	
Suspension	Front	Type	Parabolic leaf springs with shock absorbers and stabilizers	
	Rear 1	Type	Air bag suspension with shock absorber and mechanical height control	
	Rear 2	Type	Liftable air bellow suspension	
Steering	Type		Telescopic and Tilt Steering Column with Locking Device, Recirculating Ball with Hydraulic Booster, Integral Type	
Wheels and Tires	Tire Size		295 / 80 R22.5; Eleven (11) [including One (1) Spare Tire]	
	Rim Size		Ten (10) - Stud Wheels (ISO Type); 22.5 x 8.25	
Electrical	Type		24V, Negative Earth	
	Battery		12V x 2, Series Connection; 432kC (120 A - h) at 20-hour rate	
	Alternator Capacity		24V, 60Amp	
Fuel Tank Capacity	L		390	

## PERFORMANCE

G.C.W Rating		kg	66,000
Performance	Max. Speed	km/h	90
	Gradeability	(tan Ø) %	52
Transmission Gear Ratio	1st		14.68 / 12.05
	2nd		9.92 / 8.14
	3rd		6.78 / 5.56
	4th		4.57 / 3.75
	5th		3.22 / 2.64
	6th		2.17 / 1.78
	7th		1.49 / 1.22
	8th		1.00 / 0.82
Rear Axle Carrier	Reverse		14.14 / 11.60
	Model		SH19
	Ratio		4.333

## DIMENSION AND MASS

Chassis Mass	Front	kg	4,685
	Rear	kg	3,205
	Total	kg	7,890
Wheelbase (WB)	mm	3,330 + 1,330	
Overall Length (OL)	mm	7,035	
Overall Width (OW)	mm	2,490	
Overall Height (OH)	mm	3,015	
Rear Overhang (ROH)	mm	995	
Front Tire Tread (FT)	mm	2,050	
Rear Tire Tread (RT)	mm	1,840	
Turning Radius (On tire)	mm	7,400	
Seating Capacity	mm	2	

**HINO MOTORS SALES (MALAYSIA) SDN. BHD.** is engaged in an ongoing research and development program, and reserves the right to change specification without prior notice in order to pass on to the customer any resulting advances or technical refinements. All specifications of the product are within normal manufacturing allowances and tolerances.

Dimensions are based on JPJ Body Plan Approval. It may vary +/- 50 mm from the actual body constructions.

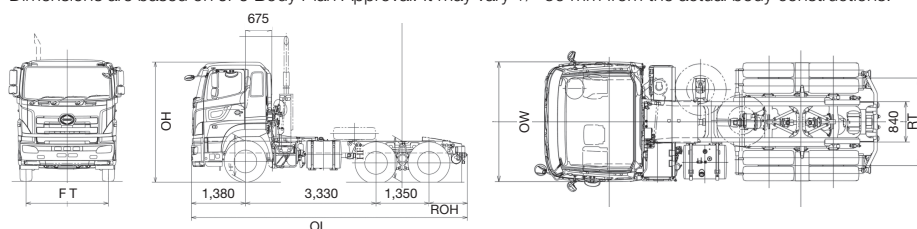

HINO Authorized Dealer:

Ver.02/09.2022